

Super Brute

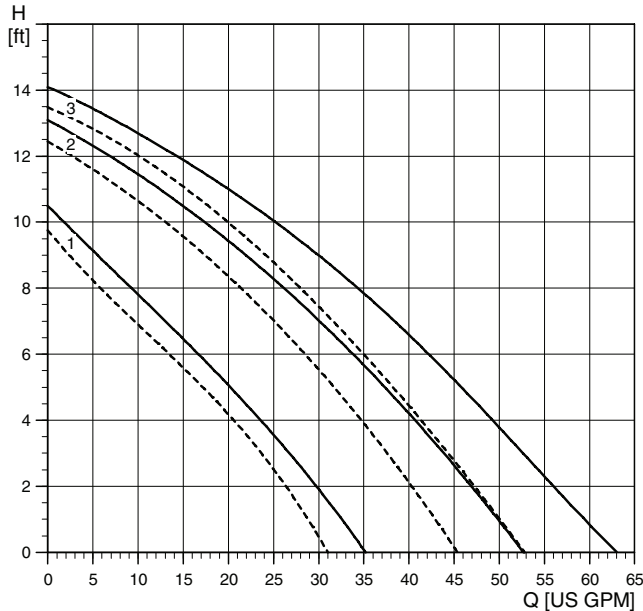

UPS 43-44FC

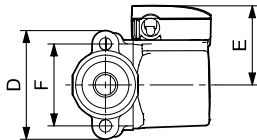
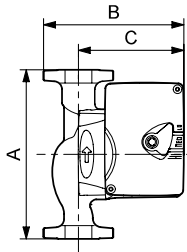

TM03 8196 0807

TM03 8757 2407

Flow range: 0-63 U.S. gpm
 Head range: 0-14 feet
 Motors: 2-pole, single-phase
 Max. liquid temperature: 230 °F (110 °C)
 Min. liquid temperature: 32 °F (0 °C)
 Max. system pressure: 145 psi

| Model | Spd | Volts | Amps | Watts | Hp | Capacitor |
|-----------------|-----|-------|------|-------|-----|------------|
| UPS 43-44FC/BFC | 3 | 115 | 1.8 | 203 | 1/6 | 20µF/180 V |
| | 2 | | 1.7 | 189 | 1/6 | 20µF/180 V |
| | 1 | | 1.4 | 157 | 1/6 | 20µF/180 V |
| UPS 43-44FC/BFC | 3 | 230 | 0.9 | 203 | 1/6 | 5µF/400 V |
| | 2 | | 0.8 | 190 | 1/6 | 5µF/400 V |
| | 1 | | 0.7 | 157 | 1/6 | 5µF/400 V |

— Without check valve

- - - With check valve

| Position | System type | Description |
|----------|----------------------------|--------------|
| 3 | Closed (FC) and open (BFC) | High speed |
| 2 | Closed (FC) and open (BFC) | Medium speed |
| 1 | Closed (FC) and open (BFC) | Low speed |

| Model type | Product number | | A | B | C | D | E | F | Connection type and size | Shipping weight [lbs] |
|--------------|----------------|----------|-------|---------|-------|-------|--------|--------|---|-----------------------|
| | 115 V | 230 V | | | | | | | | |
| UPS 43-44FC | 52722514 | 52722515 | 8 1/2 | 6 11/16 | 5 1/8 | 4 3/4 | 3 3/16 | 3 7/16 | GF 15/26 flange (2) 1/2" dia. bolt boles | 13 1/2 |
| UPS 43-44BFC | 52722520 | 52722521 | 8 1/2 | 6 11/16 | 5 1/8 | 4 3/4 | 3 3/16 | 3 7/16 | GF 15/26 flange (2) 1/2" dia. bolt boles | 13 1/2 |

Note: The check valve can be removed.